

Ganze Muffe - 433

DIN EN 10241 (DIN 2986), mittelschwere Ausführung,

Rp-DIN EN 10226-1 / ISO 7-1

Socket - 433

DIN EN 10241 (DIN 2986), medium heavy type,

Rp-DIN EN 10226-1 / ISO 7-1

Abm./Dim.	D mm	L mm	Kg/Stk/pc	EN 1.4571
				Artikel-Nr. Article-No.
1/8"	15,00	17,00	0,011	● 35467
1/4"	18,50	25,00	0,021	● 35466
3/8"	21,30	26,00	0,035	● 35474
1/2"	26,60	34,00	0,062	● 35465
3/4"	31,80	36,00	0,080	● 35473
1"	39,50	43,00	0,144	● 35470
1 1/4"	48,30	48,00	0,202	● 35469
1 1/2"	54,50	48,00	0,237	● 35468
2"	66,20	56,00	0,348	● 35472
2 1/2"	82,00	65,00	0,552	● 35471
3"	95,00	71,00	0,772	● 35475
4"	121,40	83,00	1,700	● 35476

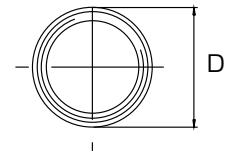
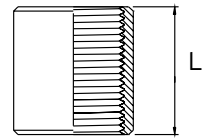

G-ISO DIN 228

1/4"	18,50	25,00	0,062	● 761111
------	-------	-------	-------	----------

Ganze Muffe - 433 W2

DIN EN 10241 (DIN 2986), mittelschwere Ausführung,

AD-W2, Rp-DIN EN 10226-1 / ISO 7-1

Socket - 433 W2

DIN EN 10241 (DIN 2986), medium heavy type,

AD-W2, Rp-DIN EN 10226-1 / ISO 7-1

Abm./Dim.	D mm	L mm	Kg/Stk/pc	EN 1.4571
				Artikel-Nr. Article-No.
1/4"	18,50	25,00	0,021	● 35505
3/8"	21,30	26,00	0,035	● 35511
1/2"	26,60	34,00	0,062	● 35504
3/4"	31,80	36,00	0,080	● 35510
1"	39,50	43,00	0,144	● 35508
1 1/4"	48,30	48,00	0,202	● 35507
1 1/2"	54,50	48,00	0,237	● 35506
2"	66,20	58,00	0,348	● 35509

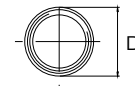
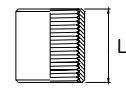

Ganze Muffe - 433
nach Werksnorm TS 53-1100,
hergestellt aus Stabstahl, Rp-ISO 7-1

Socket - 433
according to factory standard TS 53-1100,
made of round bars, Rp-ISO 7-1

Abm./Dim.	D mm	L mm	Kg/Stk/pc	EN 1.4571	Artikel-Nr. Article-No.
1/2"	27,00	35,00	0,100	● 761100	
3/4"	32,50	50,00	0,235	● 761101	
1"	39,50	50,00	0,360	● 761102	
1 1/4"	49,00	55,00	0,510	● 761103	
1 1/2"	56,00	55,00	0,780	● 761104	

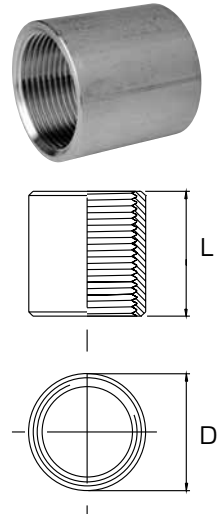

Ganze Muffe - 333 NPT
mit NPT Gewinde

Socket - 333 NPT
with NPT thread

Abm./Dim.	D mm	L mm	Kg/Stk/pc	EN 1.4571	Artikel-Nr. Article-No.
1/4"	18,50	25,00	0,021	● 35129	
3/8"	21,30	26,00	0,035	● 35135	
1/2"	26,60	34,00	0,062	● 35128	
3/4"	31,80	36,00	0,080	● 35134	
1"	39,50	43,00	0,144	● 35132	
1 1/4"	48,30	48,00	0,202	● 35131	
1 1/2"	54,50	48,00	0,237	● 35130	
2"	66,20	56,00	0,348	● 35133	

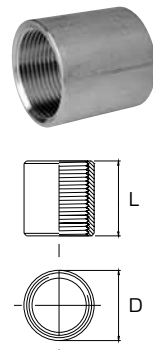

Ganze Muffe - 433 H

DIN EN 10241 (DIN 2986), mittelschwere Ausführung,
einseitig mit 30° Fase, Rp-DIN EN 10226-1 / ISO 7-1

Socket - 433 H

DIN EN 10241 (DIN 2986), medium heavy type,
on one side with 30 degree bevel, Rp-DIN EN 10226-1 / ISO 7-1

Abm./Dim.	D mm	L mm	Kg/Stk/pc	EN 1.4571
				Artikel-Nr. Article-No.
1/4"	18,50	25,00	0,021	● 35486
3/8"	21,30	26,00	0,035	● 35492
1/2"	26,60	34,00	0,062	● 35485
3/4"	31,80	36,00	0,080	● 35491
1"	39,50	43,00	0,144	● 35489
1 1/4"	48,30	48,00	0,202	● 35488
1 1/2"	54,50	48,00	0,237	● 35487
2"	66,20	58,00	0,348	● 35490

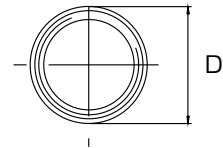
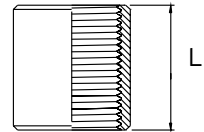

Ganze Muffe - 433 V

DIN EN 10241 (DIN 2986), mittelschwere Ausführung,
Rp-DIN EN 10226-1 / ISO 7-1

Socket - 433 V

DIN EN 10241 (DIN 2986), medium heavy type,
Rp-DIN EN 10226-1 / ISO 7-1

Abm./Dim.	D mm	L mm	Kg/Stk/pc	EN 1.4541
				Artikel-Nr. Article-No.
1/8"	15,00	17,00	0,011	● 35495
1/4"	18,50	25,00	0,021	● 35494
3/8"	21,30	26,00	0,035	● 35502
1/2"	26,60	34,00	0,062	● 35493
3/4"	31,80	36,00	0,080	● 35501
1"	39,50	43,00	0,144	● 35498
1 1/4"	48,30	48,00	0,202	● 35497
1 1/2"	54,50	48,00	0,237	● 35496
2"	66,20	56,00	0,348	● 35500
2 1/2"	82,00	65,00	0,552	● 35499
3"	95,00	71,00	0,772	● 35503

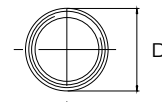
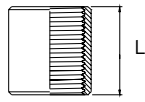

Anschweissmuffe - 433 CS
Innengewinde, Schweissende,
Rp-DIN EN 10226-1 / ISO 7-1
Welding socket - 433 CS
female thread, weld-on end,
Rp-DIN EN 10226-1 / ISO 7-1

Abm./Dim.	D1 mm	D2 mm	L mm	S mm	Kg/Stk./pc	EN 1.4571	Artikel-Nr. Article-No
1/4"	18,50	13,50	25,00	2,30	0,024		● 35478
3/8"	21,30	17,30	26,00	2,30	0,032		● 35484
1/2"	26,50	21,30	34,00	2,60	0,051		● 35477
3/4"	31,80	26,90	36,00	2,60	0,070		● 35483
1"	39,50	33,70	48,00	3,20	0,127		● 35481
1 1/4"	48,30	42,40	48,00	3,20	0,207		● 35479
1 1/2"	54,50	48,30	48,00	3,20	0,173		● 35480
2"	66,30	60,30	56,00	3,60	0,286		● 35482

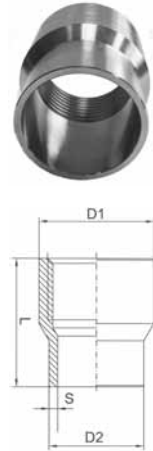

Halbe Muffe - 434
DIN EN 10241 (DIN 2986), mittelschwere Ausführung,
einseitig mit 30° Fase, Rp-DIN EN 10226-1 / ISO 7-1
Half Socket - 434
DIN EN 10241 (DIN 2986), medium heavy type,
on one side with 30 degree bevel, Rp-DIN EN 10226-1 / ISO 7-1

Abm./Dim.	D mm	L mm	Kg/Stk./pc	EN 1.4541	1.4571	Artikel-Nr. Article-No	Artikel-Nr. Article-No
1/8"	15,00	8,00	0,005				● 35514
1/4"	18,50	11,00	0,008				● 35513
3/8"	21,30	12,00	0,012				● 35521
1/2"	26,60	16,00	0,023				● 35512
3/4"	31,80	17,00	0,041				● 35520
3/4"	34,00	17,00	0,260	● 761115			
1"	39,50	20,00	0,060				● 35517
1 1/4"	48,30	22,00	0,088				● 35516
1 1/2"	54,50	22,00	0,101				● 35515
2"	66,20	26,00	0,143				● 35519
2 1/2"	82,00	30,00	0,290				● 35518
3"	95,00	34,00	0,350				● 35522
4"	121,40	40,00	0,830				● 35523

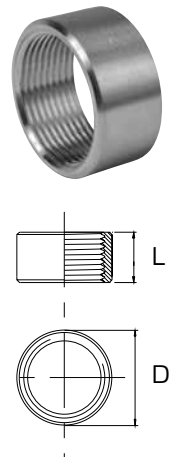

Reduziermuffe - 335

ähnl. DIN EN 10241 / ISO 4144 (DIN 2991),

Rp-DIN EN 10226-1 / ISO 7-1

Socket reduced - 335

similar to DIN EN 10241 / ISO 4144 (DIN 2991),

Rp-DIN EN 10226-1 / ISO 7-1

Abm./Dim.	A mm	B mm	Kg/Stk./pc	AISI 304 Artikel-Nr. Article-No	AISI 316 Artikel-Nr. Article-No
1/4" x 1/8"	18,00	22,80	0,045		● 24136
3/8" x 1/4"	22,00	22,00	0,049	● 35139	
3/8" x 1/4"	22,00	22,00	0,059		● 24137
1/2" x 1/4"	26,00	25,00	0,120		● 24138
1/2" x 3/8"	26,00	28,00	0,150		● 24139
3/4" x 3/8"	32,00	24,50	0,133		● 24140
3/4" x 1/2"	32,00	32,50	0,149		● 24141
1" x 3/8"	39,00	27,00	0,156		● 35136
1" x 1/2"	39,00	29,50	0,213		● 24142
1" x 3/4"	39,00	36,40	0,234		● 24143
1 1/4" x 3/4"	48,00	33,00	0,292		● 24145
1 1/4" x 1"	48,00	42,00	0,319		● 24146
1 1/2" x 3/4"	54,00	33,00	0,320		● 29973
1 1/2" x 1"	54,00	34,50	0,406		● 24147
1 1/2" x 1 1/4"	54,00	44,30	0,416		● 24148
2" x 1/2"	66,00	35,50	0,438		● 35137
2" x 1"	66,00	38,00	0,438		● 35138
2" x 1 1/2"	66,00	47,80	0,623		● 24149
2 1/2" x 2"	81,20	47,00	0,557		● 24150

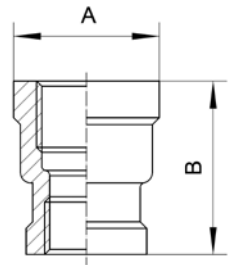

Reduziermuffe - 435
DIN EN 10241 (DIN 2988),
Rp-DIN EN 10226-1 / ISO 7-1
Socket reduced - 435
DIN EN 10241 (DIN 2988),
Rp-DIN EN 10226-1 / ISO 7-1

Abm./Dim.	A mm	SW mm	L mm	Kg/Stk./pc	EN 1.4571
					Artikel-Nr. Article-No
1/4" x 1/8"	18,00	15,00	27,00	0,028	● 35526
3/8" x 1/4"	21,00	19,00	30,00	0,042	● 35538
1/2" x 1/4"	27,00	36,00	36,00	0,079	● 35524
1/2" x 3/8"	27,00	24,00	36,00	0,079	● 35525
3/4" x 1/2"	34,00	39,00	39,00	0,090	● 35535
3/4" x 1/4"	34,00	39,00	39,00	0,091	● 35536
3/4" x 3/8"	34,00	39,00	39,00	0,091	● 35537
1" x 1/2"	40,00	45,00	45,00	0,160	● 35532
1" x 3/4"	40,00	45,00	45,00	0,162	● 35533
1 1/4" x 1/2"	50,00	50,00	50,00	0,267	● 35529
1 1/4" x 3/4"	50,00	50,00	50,00	0,267	● 35531
1 1/4" x 1"	50,00	50,00	50,00	0,252	● 35530
1 1/2" x 1"	57,00	55,00	55,00	0,470	● 35528
1 1/2" x 1 1/4"	57,00	55,00	55,00	0,432	● 35527
2" x 1 1/2"	72,00	65,00	65,00	0,644	● 35534

